



## Machinery List

### **(10) CNC Mill Machines:**

CNC Excel Milling machines are fully equipped along with the latest version of Shop Talk programs to meet the quality and quantities our customers demand.

- (5) Excel MC 10T24 equipped with a 4 axis center, a 10"3 bison chuck, and a Fanuc series 21M control.
- (3) Excel 810 equipped with a 4 axis center, a 10"3 bison chuck, and a Fanuc series 0-M 41 control.
- (1) Haas VF-3YT/50 equipped with a 4 axis center
- (1) Mori Seiki MV-40 equipped with a 4 axis center, an 8" chuck and a Fanuc 10M control.







## (20) CNC Lathe Machines

- CNC Mazak, HAAS, and Mori Seiki Lathe machines are fully equipped along with the latest version of Shop Talk programs to produce the highest quality product and quantities our customers demand.
- (5) Mazak M4 equipped with a 12" chuck X 60" table, 3" hollow spindle, and a Fanuc 6T control
- (5) Mazak M4 equipped with a 12" chuck X 60" table, 3" hollow spindle, and a Mazatrol-T1 control.
- (1) Mazak M4 equipped with a 12" chuck X 60" table, 3" hollow spindle, and a Mazatrol-T2 control
- (1) Mazak M5 equipped with a 20" chuck X 80" table, 3" hollow spindle, and a Mazatrol-T2 control.
- (1) Mazak M5 equipped with a 20" chuck X 80" table, 3" hollow spindle, and a Mazatrol-T1 control.
- (2) Mazak M5 equipped with a 20" chuck X 80' table, 3" hollow spindle, and a Fanuc 6T control.
- (1) HAAS lathe SL-30T equipped with a 10" chuck X 30" table, 3.25" hollow spindle, and Fanuc control
- (1) Mori Seiki TL-5B-1000 equipped with a 12" chuck X 36" table, 3.5" hollow spindle, and a Fanuc 6T control.
- (1) Mori Seiki SL-25 equipped with a 10" chuck X 36" table, 3" hollow spindle, and a Fanuc MSC-516 control.
- (1) Mori Seiki TL equipped with a 15" chuck X 36" table, 3.5" hollow spindle, and a Fanuc 6T control.
- (1) Mori Seiki TL equipped with a 8" chuck X 26" table, 3.5" hollow spindle, and a Fanuc OM control.

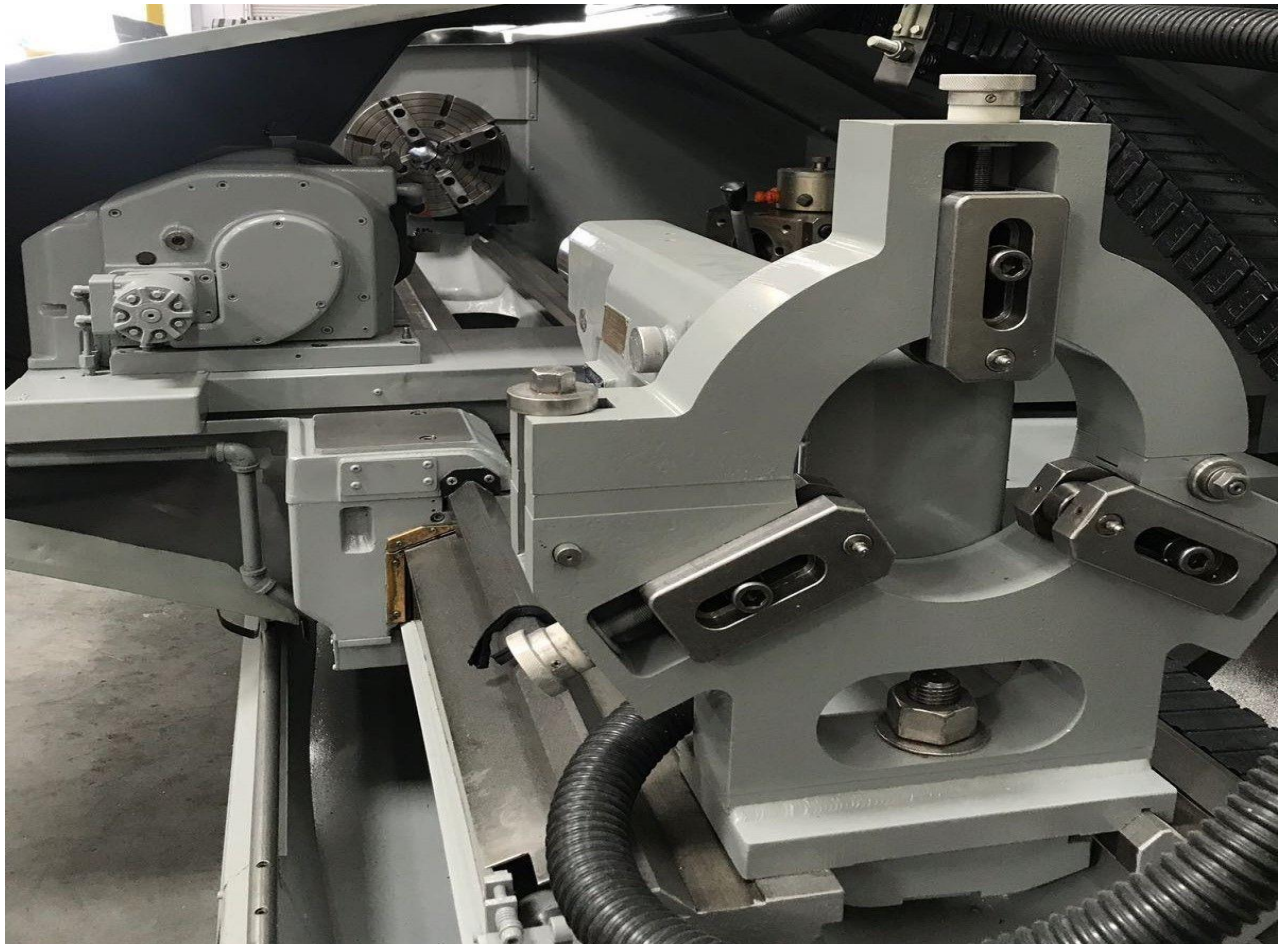

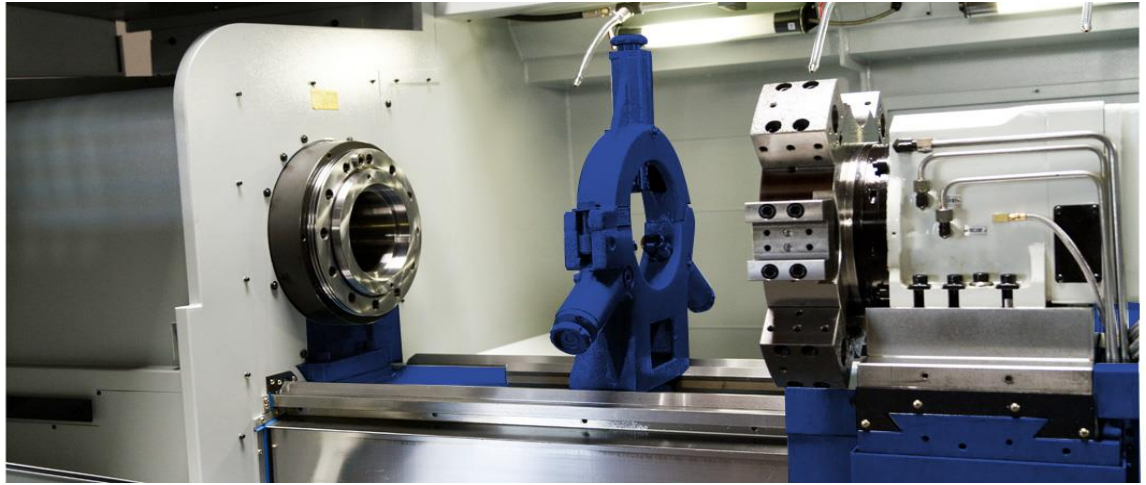







## (10) Mill Machines:

Milling machines operate with the capabilities to meet demands with the continuance of production without changing the set-up.

- (5) Bridgeport 2J equipped with a 42" table.
- (1) Bridgeport 2J equipped with a 48" table.
- (1) Lagun FTV equipped with a 60" table.
- (1) Milwaukee 420 TF-17 equipped with a 50" table.
- (1) Milwaukee 205 S-12 equipped with a 48" table.
- (1) Rutland 2680 equipped with a 42" table.

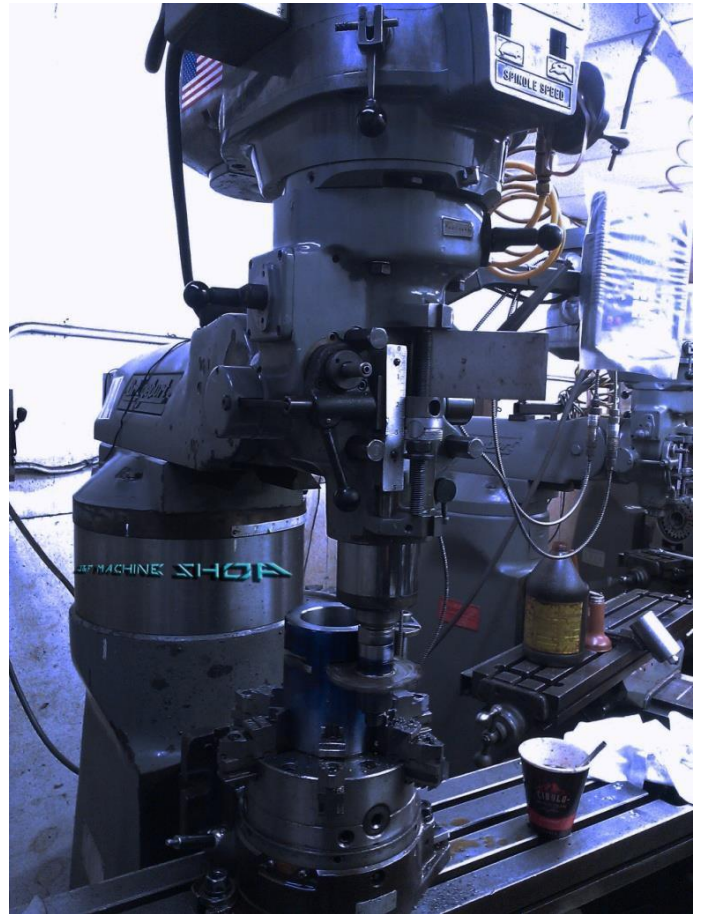



## (22)     Lathe Machines:

Lathe machines operate with the capabilities to meet demands in a variety of sizes and lengths.

- 2) Kingston HL-2290 running at 22"x90"xH22"x90"
- (1) Yamazaki 2408 running at 24"x80"
- (1) Le Blonde 2408 running at 22"x80" size 15"
- (1) Le Blonde HL-3000 running at 21"x120"xH24"x120"
- (1) Kuraki KH6-30 running at 26"x128"
- (1) Herbert 9C-30 running at 28"x6"x44"
- (1) Revolver running at 150"x25"x10"
- (1) Revolver running at 95"x21"x6.25"
- (4) Revolver running at 84"x16"x7.5"
- (1) Mazak 30 running at 120"x30"x12"
- (2) Kingston HL-1500 running at 21"x60"xH24"x60"
- (2) Kingston HL-2000 running at 21"x80"xH21"x80"
- (1) Kingston HL-2500 running at 21"x100"xH24x100"
- (2) Kingston HL-3000 running at 21"x120"xH24x120"
- (1) Poreba 14205 running at 130"x25"x10"





### **(13) Quality Control Devices:**

Quality control devices are kept up to date with their calibrations in order to assure superlative quality

- (1) Comparator PH-3500. Mitutoyo profile projector.
- (1) Height Gage. Mitutoyo Linear Height-600.
- (2) King Hardness Test. Portable Brinell – Hardness Tester.
- (1) Mitutoyo Hardness Test. Hardness testing Machine AR (Rockwell).
- (1) GageMaker program\*.
- (5 guns) GageMaker rolls. GageMaker Rolls/Guns\*.
- (1) Glastonbury Caliper. 1-6"x1" caliper master.
- (1) Glastonbury Caliper. Vernier Caliper Master 12"

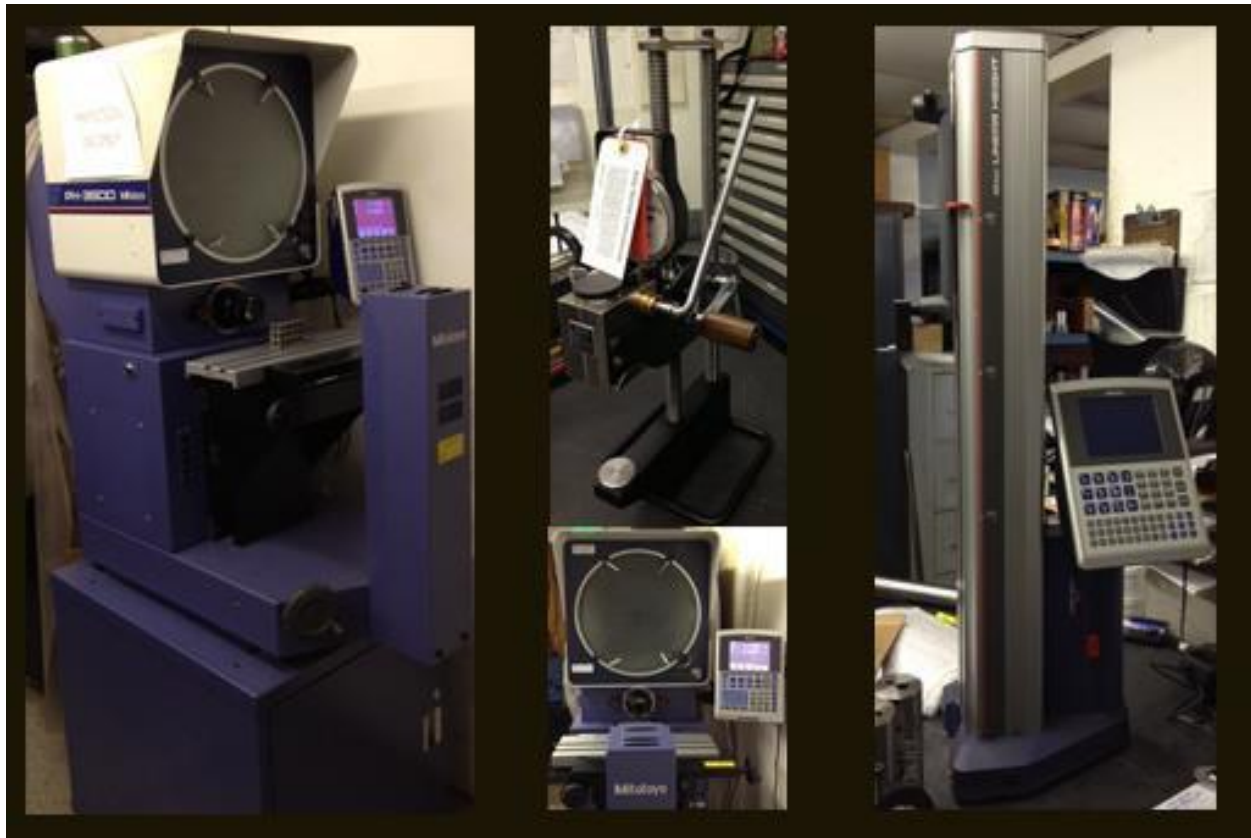

\*Threading capabilities (include, but are not limited to): National, Acme, Stub Acme, double lead helical thread, buttress, API (IF, regular, taper), AMMT, and CAS.

**\*\*Machinery and Material Capabilities\*\* (include, but are not limited to):**

- Carbon Steel 4140, 4130, 1018, 8620, 8630, HQ125
- Stainless Steel (i/e: 304, 316, 17-4 PH)
- Aluminum (i/e: 6000 series, 7000 series)
- Inconel (i/e: 718, 925)
- Chrome: 13 chrome, super 13 chrome, 25 Chrome MP35
- Titanium
- Beryllium
- Copper
- Amcoloy 25
- Hastelloy
- K-Monel
- Plastic (all types)
- Rubber composites, Nylon.

**Job Sizes:**

- OD: Specialized in parts 10" in Diameter or smaller, capable of machining parts up 15" in diameter
- Parts less than 1" in diameter
- Length: Specializing in parts 100" L or shorter, capable of machining parts up to 150" L
- We are equipped to machine parts up to 20" in diameter on a case by case basis based on the part's configuration.